



Silhouette printable tattoo paper

Starter Guide

1



Open your desired image in the Silhouette software and MIRROR IT SO THE IMAGE IS REVERSED.

2



Before printing, verify registration marks are visible and then feed your tattoo paper into your printer so it will print on the glossy side. Use your printer's photo paper settings if available.*

3



Your adhesive sheet has two sections of backing. Peel away the narrow section on the end.

4

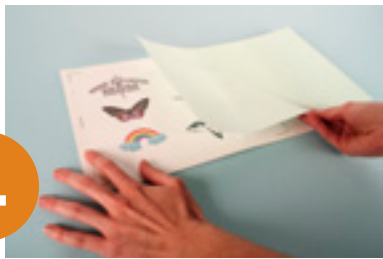

Align the strip of exposed adhesive with your printed image. With that in place, peel the larger section of backing off smoothing down the adhesive sheet as you go.

5

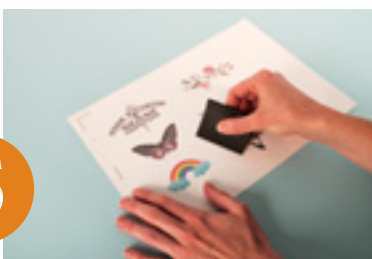

Use your scraper tool to rub the adhesive sheet onto the printed image.

6



Load your printed sheet into the Silhouette. *Use the pink cap and a cutting thickness of 23-28 and a speed of 3-5. Tattoo paper requires a "double cut". To do this, copy and paste the image on top of itself or select the "double cut" option in Silhouette Studio.

7



Take your cut out tattoo and peel away the clear plastic layer exposing the adhesive.

8



Apply the tattoo's adhesive side to your skin and cover with a wet cloth for 10-15 seconds or until paper backing slides off easily.

9



Temporary tattoos generally last a day and can be removed with a washcloth